



ZTXSAND



TECHNICAL CHARACTERISTICS - CARATTERISTICHE TECNICHE

VOLUME - PORTATA		PRESSURE - PRESSIONE		
l/min	G.P.M. (USA)	bar	P.S.I.	Mpa
8 ÷ 50	2.1 ÷ 13.2	70 ÷ 250	1000 ÷ 3600	7 ÷ 25

MODEL - MODELLO	SUITABLE FOR - UTILIZZABILE PER
ZTXSAND 0	IP 130 - IP 140 - IP 150 - IP 170 T 8.90 - T 10.100 - T 11.120 TX IPX TSX 10.130 - TX IPX TSX 12.140 TX IPX TSX 13.180 - TX IPX TSX 956 TX300 10.130 - TX300 13.160 - TX300 14.180 TX500 15.200 - TX500 15.250
ZTXSAND 1	TX IPX TSX 12.100 - TX IPX TSX 14.120 TX IPX TSX 15.150 - TX IPX TSX 951 - TX IPX TSX 961
ZTXSAND 2	TX IPX TSX 17.130 - TX IPX TSX 954 TX500 18.170 - TX500 21.200
ZTXSAND 3	TX IPX TSX 957 - TX500 21.150

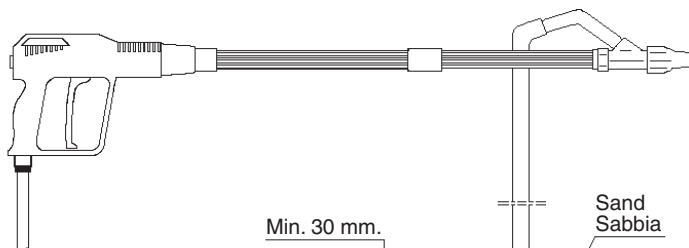

USE DRY SIFTED SAND USARE SABBIA ASCIUTTA E SETACCIATA

TYPE OF SANDBLASTING TIPO DI SABBIAIATURA	TYPE OF SAND TIPO DI SABBIA	Ø
LIGHT LEGGERA	QUARZ QUARZO	Inch. 0 ÷ 0.02 mm 0 ÷ 0.5
STANDARD	QUARZ QUARZO	Inch. 0.024 ÷ 0.035 mm 0.6 ÷ 0.9
HEAVY PESANTE	SILICA SILICEA	Inch. 0.035 ÷ 0.055 mm 0.9 ÷ 1.4

SAND CONSUMPTION:
460 ÷ 860 lbs/h

CONSUMO SABBIA:
210 ÷ 390 kg/h

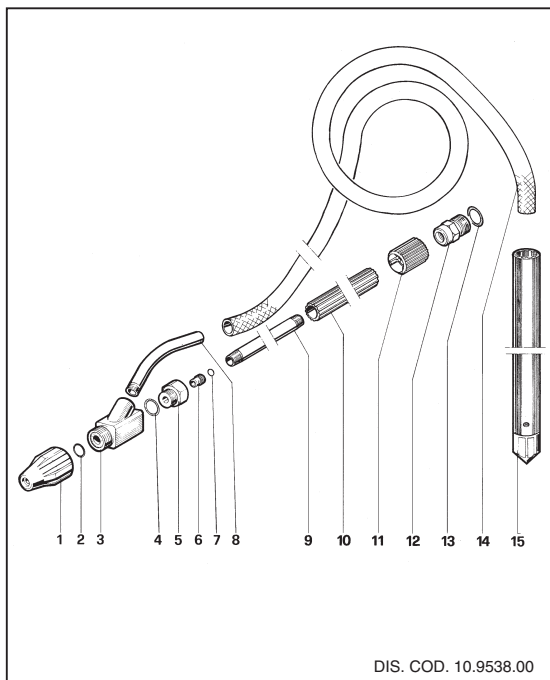

DIS. COD. 10.9538.00

POS.	CODE CODICE	DESCRIPTION DESCRIZIONE	N. PCS.
1	10.7050.01	Assieme ghiera e ugello Ø6	1
2	90.3828.00	OR Ø 12,37x2,62	1
3	10.0762.01	Corpo	1
4	90.3593.00	OR Ø 15,6x1,78	1
5	10.0129.70	Nipplo portaugello	1
6	10.0141.66	Ugello Ø 1,5 - Testina Nr. 0	1
	10.0133.66	Ugello Ø 1,6 - Testina Nr. 1	1
	10.0134.66	Ugello Ø 1,7 - Testina Nr. 2	1
	10.0135.66	Ugello Ø 1,85 - Testina Nr. 3	1
7	90.3576.00	OR Ø 6,75x1,78	1
8	10.0137.89	Tubo portagomma	1
9	18.0127.89	Tubo G1/4"	1
10	18.0126.98	Impugnatura	1
11	10.0542.51	Protezione	1
12	ZINA 1/4"F	Nipplo 1/4"F - M22x1,5	1
13	90.3845.00	OR Ø 18,72x2,62	1
14	10.0320.98	Tubo	1
15	ZTESOND	Tubo aspirazione sabbia	1



INTERPUMP GROUP

VIA E. FERMI, 25 - 42049 S. ILARIO - REGGIO EMILIA (ITALY)

TEL. +39 - 0522 - 904311 - TELEFAX + 39 - 0522 - 904444

E-mail: info@interpumpgroup.it - <http://www.interpumpgroup.it>